

# Restoration and Stabilization of Hooker Falls Access Area

*This is what we started with.....*



Did you notice that the tree was swept away?



February 2007

Major erosion damage occurred to the river bank during flooding in 2004 and 2005. The lack of soil-binding ground vegetation allowed floodwaters to wash away a large section of the river's edge. The Little River began to carve away at its own banks below Hooker Falls, and would continue to do so if restoration work was not undertaken.



January 2004

Did you notice that another tree was swept away?



June 2005

Look at how much the floodwaters carved away the river bank!

## Would you believe...?

You are standing on a carefully engineered and skillfully constructed sub-structure. This structure is called a modified Single-Wing Deflector. It is made up of boulders weighing nearly 5-ton! Smaller boulders are used for cross-bracing and along the perimeter wall. Geotextile sheets help to hold the rock and soil in place.

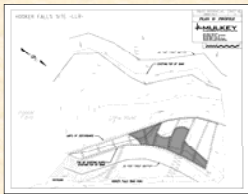

Compare with February 2007 photo at top...

## Project Partners & Cooperators



*.....And this is how we fixed it.*

Lay a perimeter foundation of large boulders to re-establish the original river bank edge.



Step 1

Install cross-bracing with smaller boulders to resist the forces of the rushing river water.



Step 2

Back-fill the pools with a mix of sand & crushed stone. Geotextile sheeting keeps the backfill from escaping through the joints between the boulders.



Step 3

All restoration construction work was performed in May 2007.

Add additional soil and sand mixture to build up the new river bank surface.



Step 4

Apply a layer of nutrient-rich topsoil to promote growth of vegetation.



Step 5

Lay some boulders, seed with grass, apply mulch and install a pathway of crushed gravel for visitor access.

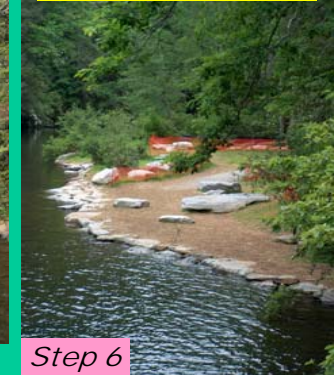

Step 6

Learn more about all of your State Forests at [www.ncesf.org](http://www.ncesf.org) or [www.dfr.state.nc.us](http://www.dfr.state.nc.us).